

INTERCEPTOR™

Power Tuning™

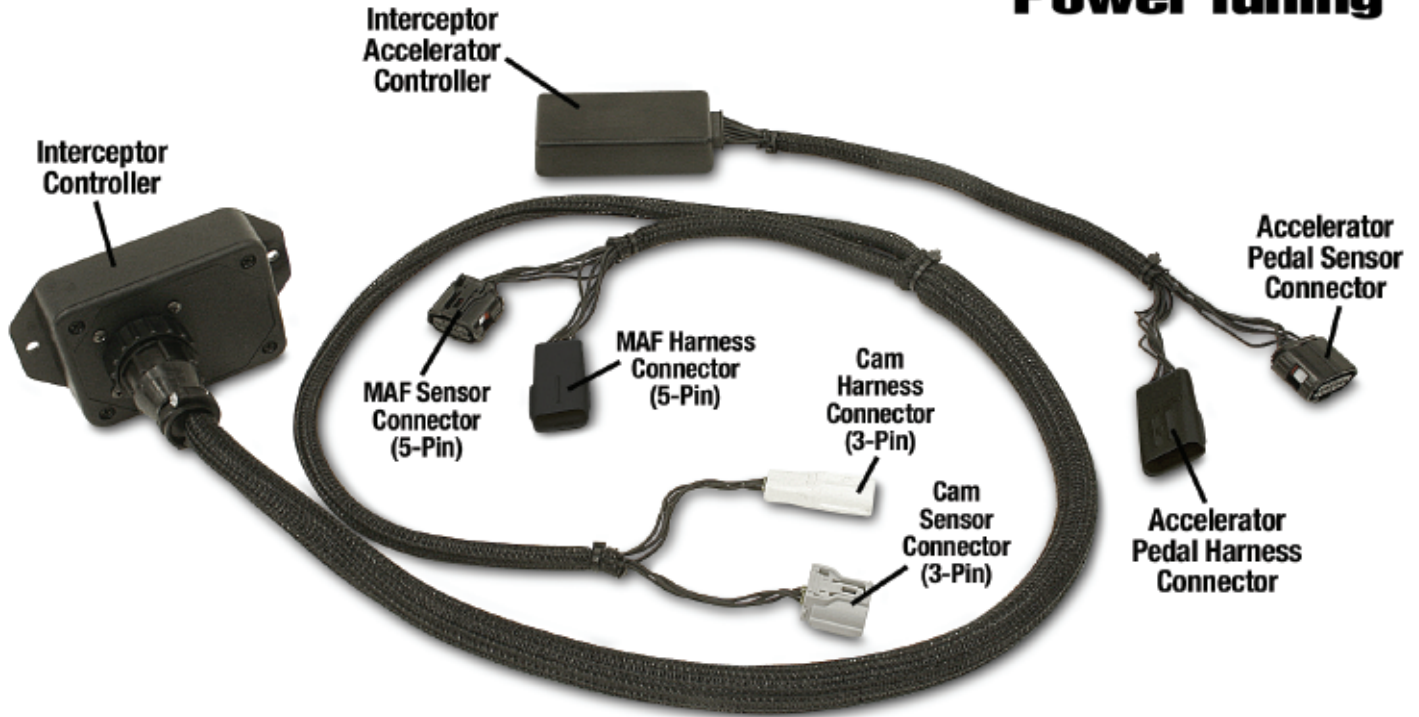

Step-By-Step Installation Instructions For:
2010-2014 Toyota Tundra 4.6 iForce, 2010-2014 Toyota Sequoia 4.6 iForce,
& 2010-2014 Lexus GX460 4.6 iForce - Part #706001

Hypertech's new product, the Interceptor, is a smart technology design that works with today's generation of complex engine computers. The Interceptor easily mounts under the hood of a vehicle and plugs into the factory connectors to constantly monitor the vehicle's functions. It then automatically recalculates the factory's computer performance calibrations with legendary Hypertech Power Tuning. ***This means more horsepower and torque, quicker acceleration, better drivability, and improved MPG.***

The Interceptor Controller easily installs under the hood in about fifteen (15) minutes. The Interceptor Accelerator Pedal Controller installs in the vehicle's interior on the driver's side above the accelerator pedal in about fifteen (15) minutes.

BEFORE installing the Hypertech Interceptor:
 Make sure the vehicle engine and ignition is turned OFF prior to beginning the installation.

Tools needed for Interceptor installation:

- flashlight

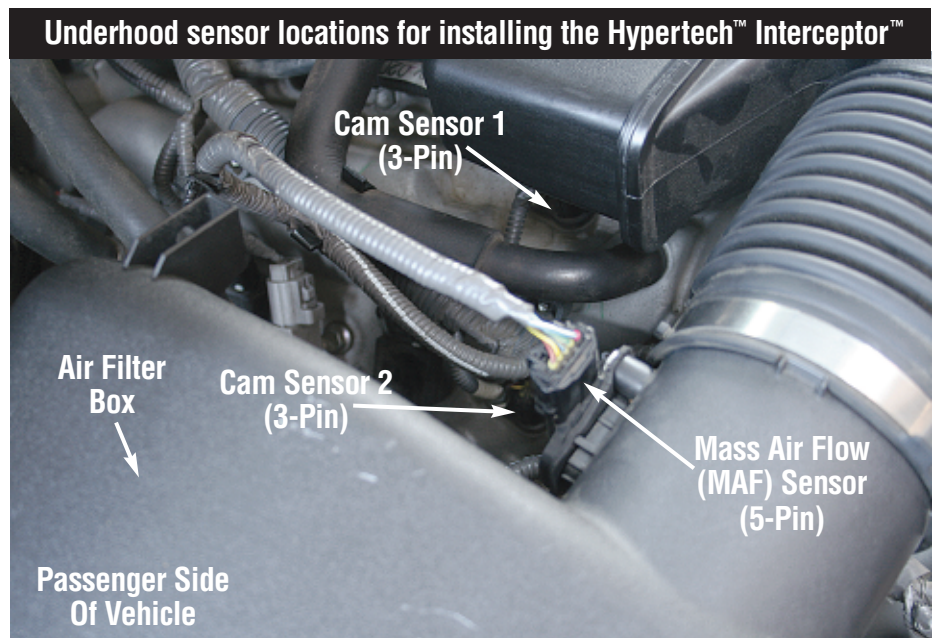

NOTE: Sensor locations may vary slightly depending on the application.

IMPORTANT NOTE: READ BEFORE INSTALLING THE INTERCEPTOR TO YOUR VEHICLE

Although the 4.6 and 5.7 iForce engines are similar in their electrical and mechanical controls Hypertech has developed specific custom tunes for each engine. The Interceptor (Part #706001) ships with the 5.7 iForce specific tuning, so if you are installing the Interceptor on a 4.6 iForce engine, you will have to update BOTH Interceptor modules using the Tuner Update software on the provided CD with the appropriate tuning for your engine.

CUSTOM TUNING FOR AFTERMARKET AIR INTAKES

Hypertech has developed custom engine tuning for popular aftermarket air intakes for the Toyota/Lexus Truck/SUV 4.6 iForce. If you have one of the air intakes listed below on your vehicle, you will first need to use the Tuner Update Software on the provided CD and update your Interceptor Controller (NOT the Accelerator Controller) so you will have the correct engine tuning to match the air intake installed on your vehicle.

- AEM® Brute Force
- aFe® Stage 2 & Stage 2Si
- Airaid® air intake
- K&N® 77 Series (metal)
- K&N® 63 Series (plastic)
- RBP™ air intake
- Volant air intake
- Stock air intake

To update both the Interceptor Controller AND Interceptor Accelerator Controller, install the update software on the CD provided and save the program to your PC, connect your Interceptor Controller/Accelerator Controller to your PC with the supplied USB cable, follow a few simple instructions, and update your Interceptor with the correct new calibration for the air intake/engine on your vehicle. Then, proceed to install your Interceptor to your vehicle.

Installing the Hypertech Interceptor Controller

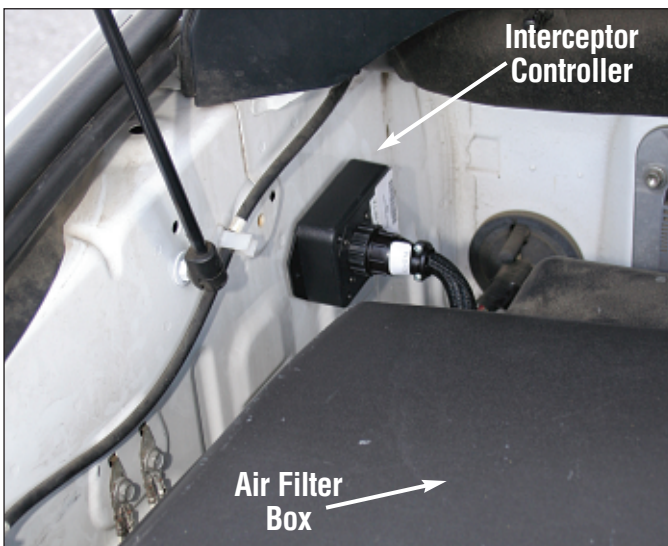

Using the supplied Velcro, attach the Interceptor Controller on the passenger side of the engine compartment as shown above.

Before proceeding to the next two (2) installation sections, lay out the Interceptor harness in the general areas of the sensor locations as shown in the engine compartment photo on page 1.

Connecting the 5-Pin Mass Air Flow (MAF) Sensor

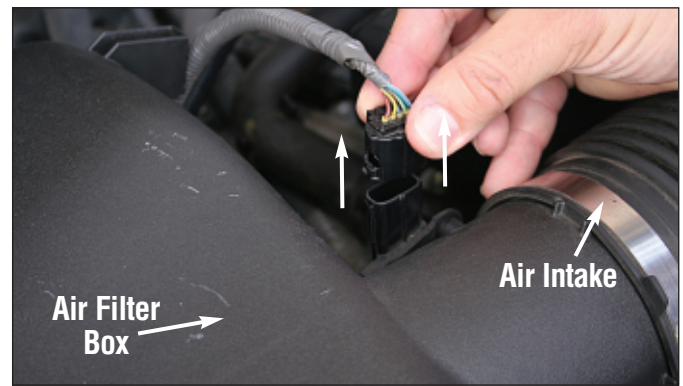

Disconnect the factory connector from the Mass Air Flow sensor. Push down on the connector, squeeze the release tab firmly, then pull up to remove the connector.

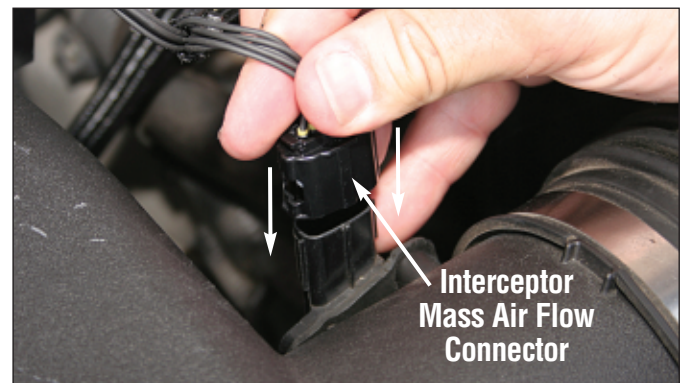

Plug the Interceptor Mass Air Flow sensor connector into the vehicle Mass Air Flow sensor.



Plug the Interceptor harness connector into the factory Mass Air Flow connector.

IMPORTANT NOTE

Make sure that the Interceptor harness and all connectors are clear from moving and/or rotating parts of the engine as well as any extreme heat sources.

Connecting the 3-Pin Cam Sensor

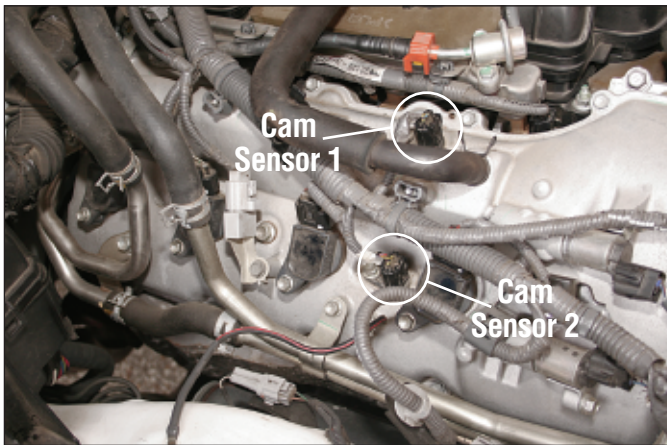

IMPORTANT NOTE: READ BELOW BEFORE INSTALLING INTERCEPTOR CAM SENSOR TO YOUR VEHICLE

NOTE: There are two (2) cam sensors on the passenger side of the vehicle. The air intake and filter box in the above photo was removed to better show the locations of these sensors. Hypertech recommends that if you have the STOCK air intake and filter box on the vehicle, to use Cam Sensor 2. If you have an AFTERMARKET AIR INTAKE installed, Hypertech recommends using Cam Sensor 1. These recommendations are for ease of access ONLY with these air intakes.



Disconnect the factory connector from the cam sensor. Push down on the connector, squeeze the release tab firmly, then pull up to remove the connector.

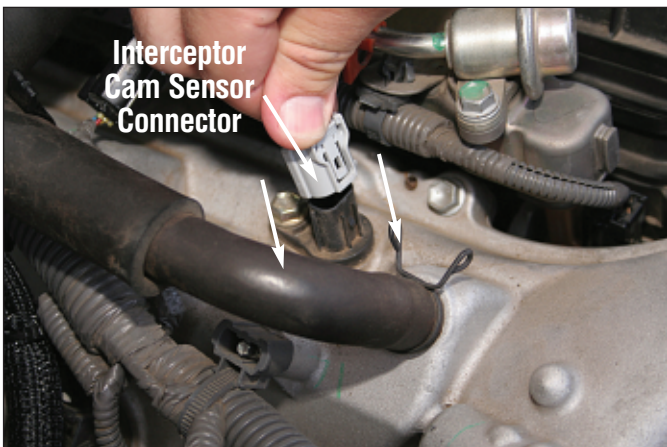

Plug the Interceptor Cam sensor connector into the Cam sensor.

Connecting the 3-Pin Cam Sensor (Cont'd)

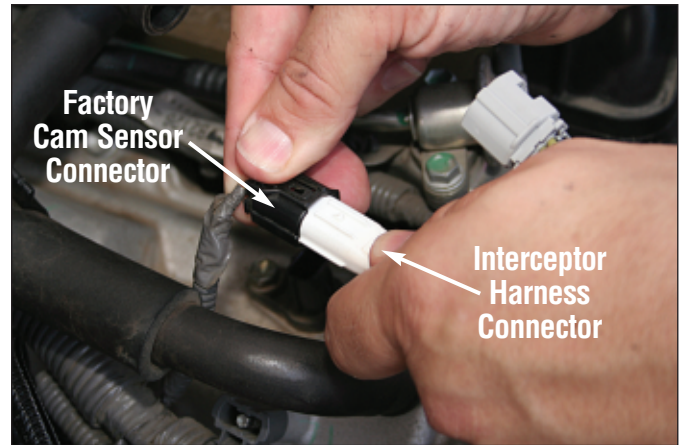

Plug the Interceptor harness connector into the factory Cam sensor connector.

IMPORTANT NOTE

Make sure that the Interceptor harness and all connectors are clear from moving and/or rotating parts of the engine as well as any extreme heat sources.

Connecting the Interceptor Accelerator Controller

IMPORTANT NOTE: READ BEFORE INSTALLING INTERCEPTOR ACCELERATOR CONTROLLER TO YOUR VEHICLE

MAKE SURE THE INTERCEPTOR ACCELERATOR CONTROLLER IS UPDATED FOR THE 4.6 iFORCE BEFORE INSTALLING TO YOUR VEHICLE (SEE PAGE 2 FOR DETAILS)

When you have updated the Interceptor Accelerator Controller for the 4.6 iForce, you can then proceed installing to your vehicle.

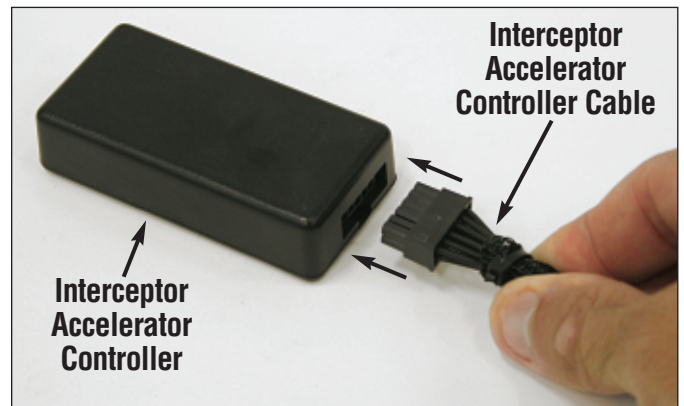

Plug the Interceptor Accelerator Controller cable into the Accelerator Controller as shown above.

Connecting the Interceptor Accelerator Controller (Cont'd)



Using a flashlight, locate the factory accelerator harness connector under the driver's dashboard and above the accelerator pedal. Disconnect the factory harness from the accelerator pedal sensor by pushing down on the connector, squeezing the release tab firmly, then pulling up to remove the connector.



Plug the Interceptor accelerator pedal sensor connector into the factory accelerator pedal sensor.

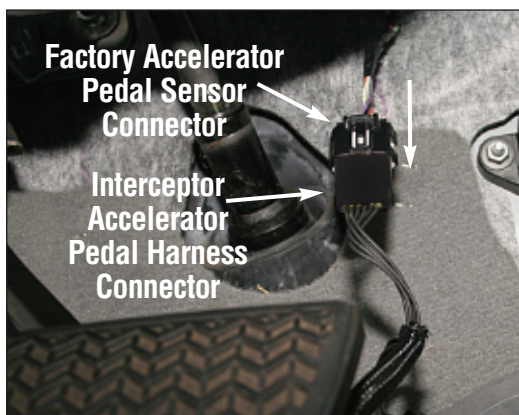

Plug the Interceptor accelerator pedal harness connector into the vehicle's factory accelerator pedal sensor connector.

Connecting the Interceptor Accelerator Controller (Cont'd)



Tuck the Interceptor accelerator controller behind the carpet and console and out of the way of the accelerator pedal, making sure all other wires/connectors are out of the way of the accelerator pedal as well. Installation is now complete! You are now ready to enjoy more power and performance with the Hypertech Interceptor!

30-Day Risk-Free, Money Back Guarantee

The 30-day money back guarantee applies to the Interceptor, Max Energy Power Programmer, Spectrum Economy Power Programmer, and the Speedometer Calibrator. ***The product MUST be returned to the place of purchase within 30 days. All items must be received in a new, unused and ready-to-sell condition (including all original packaging, parts, and paperwork) to receive a refund,*** excluding any shipping and handling fees.



Product Warranty

Factory Direct Limited 1 Year Warranty

PRODUCT WARRANTY Factory Direct Limited 1 Year Warranty.. Effective January 1, 2020 replaces and supersedes previous product warranty policy.

Hypertech products are warranted against defects in materials or workmanship for one year from the date of purchase. Hypertech's liability under this warranty shall be limited to the prompt correction or replacement of any defective part of the product which HYPERTECH determines to be necessary. This Limited 1 Year Warranty is to the original purchaser providing all the information requested is furnished. You must retain a copy of your original sales invoice or receipt. Without proper documentation, a service fee will be applied. Third Party Resellers and Resold units are NOT covered under this warranty.

* Power Tuning products are Interceptors, Max Energy Power Programmers, Spectrum, E-CON Economy Power Programmers, Speedometer Calibrators, Power Tuning Modules, Power Chips, and Power Modules. Accessories such as Power caps, Power Coil kits, and fuel pressure regulators have a one (1) year warranty.



3215 Appling Road • Bartlett, Tennessee 38133-3999
Office Hours: 8am - 5pm, Central Time, Mon. - Fri.

Tech: 901.382.8888 • Business: 901.385.1888 • Fax: 901.373.5290

For more information, go to www.hypertech.com